

Disc valve with servo-motor

Driven by 12 Volt DC



Utility model protected - Patent pending

Advantages

- 100% tight closure
 - Replaces, often noisy, nonreturn valve
 - Prevents unwanted cold drafts
 - Lowers noise pollution from the outside
- Aerodynamic design and central location in the middle of the tube, ensures minimum air resistance and thus provides a higher air flow than with a nonreturn valve.

SolarAir~

Technical specifications

Model..... **125-S-50**

A permanent 4-24 VDC current is applied to the blue and brown wire. The disc valve opens when a positive 5,5-24 VDC fase is applied to the yellow wire. When the positive fase on the yellow wire is below 4,7 VDC, the disc valve closes.



Activation Voltage..... **5,5-24 VDC**

Activation Power..... **Min. 40 mA / Max. 1A**

Open / close duration..... **14 sec.**

Driving Voltage..... **Min. 4 VDC / Max. 24 VDC**

Pipe diameter..... **Ø 125 mm**

(Can be supplied in: Ø 100 / 125 / 160 / 200 mm)

Dimensions and illustration (mm)

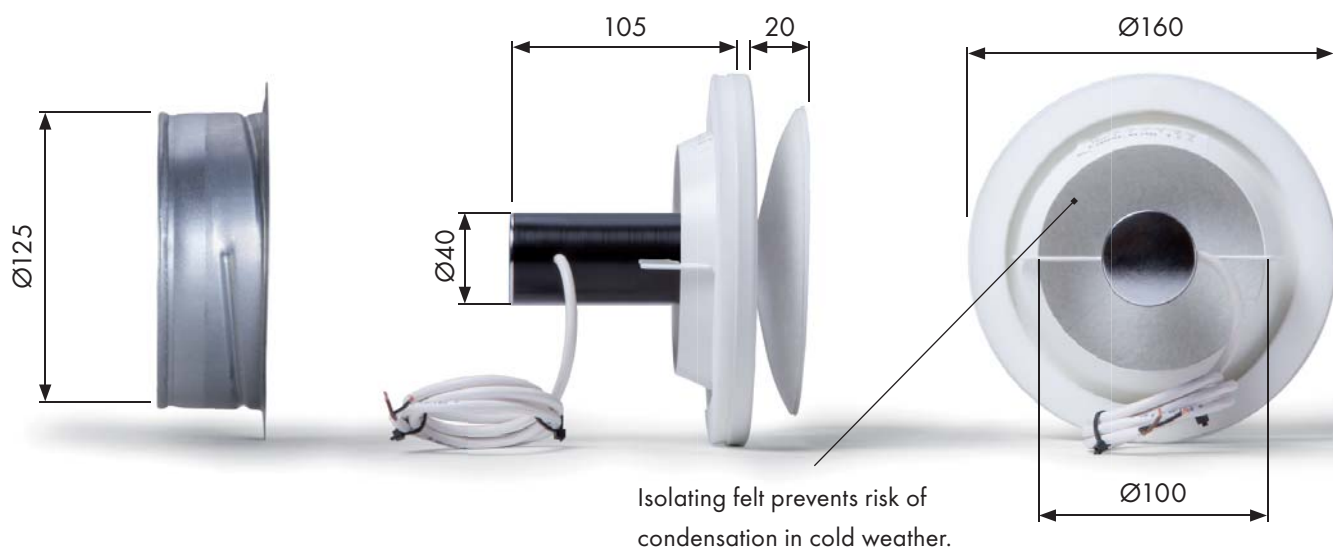

Installation instructions 1



Mounting direction



2

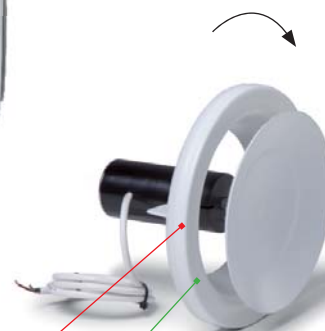

Be aware!

During installation, turn only the **outer ring**.
Do not turn the **disc plate**, as this could damage it.